

BOSTON PARK PLAZA

EST • 1927

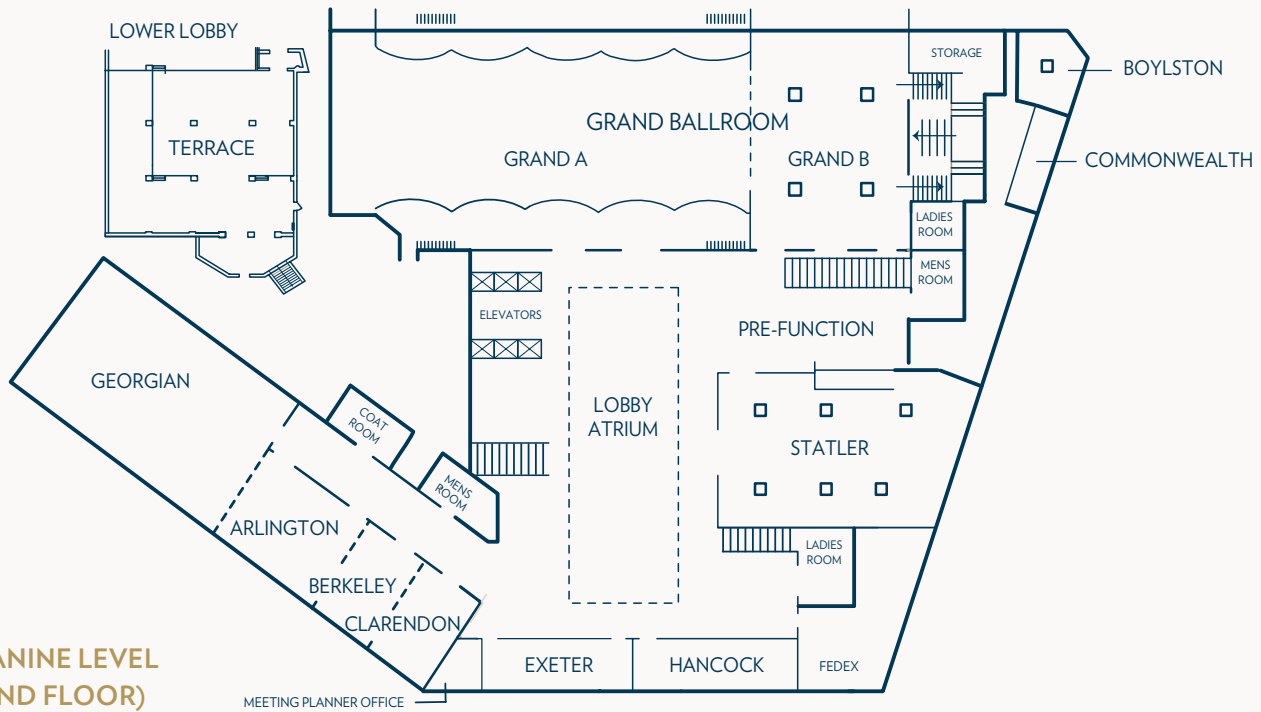

MEZZANINE LEVEL (SECOND FLOOR)

ROOM NAME	TOTAL SQUARE FEET	DIMENSIONS	CEILING HEIGHT	THEATER	BANQUET	CLASSROOM	RECEPTION	CONFERENCE	U-SHAPE
Grand Ballroom A & B *	13,215	180' x 73'	30'4"	1,130	780	597	2,200	166	171
Grand Ballroom A *	8,516	116' x 73'	30'4"	770	500	400	1,600	106	114
Balcony Left	1,430	110' x 13'	19'1"	80	30	-	-	-	-
Balcony Right	1,430	110' x 13'	19'1"	80	40	-	-	-	-
Stage	1,242	23' x 54'	-	-	-	-	-	-	-
Grand Ballroom B	4,699	64' x 73'	21'5"	342	250	198	600	70	63
Georgian	4,021	82' x 49'	13'10"	400	270	231	500	76	84
Arlington	1,402	42' x 33'	10'7"	143	120	72	200	40	42
Berkeley	748	22' x 33'	10'7"	70	50	42	100	30	27
Clarendon	732	22' x 33'	10'7"	70	50	42	100	30	27
Arlington, Berkeley, Clarendon	2,981	85' x 33'	10'7"	283	240	156	400	100	96
Georgian, Arlington, Berkeley, Clarendon	7,041	173' x 49'	10'7"	683	510	387	900	176	180
Boylston	1,210	45' x 37'	15'0"	84	70	54	120	28	27
Commonwealth	420	14' x 31'	15'0"	28	20	15	30	28	15
Exeter	560	40' x 15'	10'0"	60	30	24	50	30	27
Hancock	588	41' x 14'	11'9"	49	30	24	50	30	27
Statler	3,997	53' x 92'	8'11"	288	240	183	420	64	60
Terrace	5,330	65' x 82'	10'5"	300	250	150	400	30	27

* The height from the floor to the bottom of the chandeliers is 14'10"

BOSTON PARK PLAZA

EST • 1927

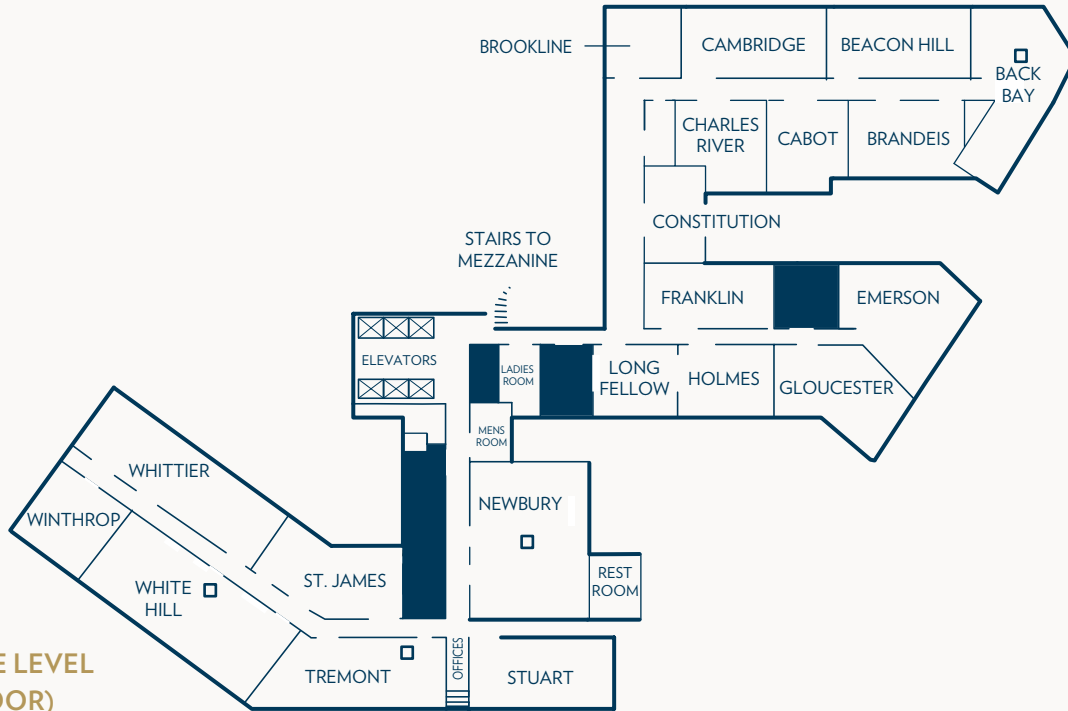

CONFERENCE LEVEL (FOURTH FLOOR)

ROOM NAME	TOTAL SQUARE FEET	DIMENSIONS	CEILING HEIGHT	THEATER	BANQUET	CLASSROOM	RECEPTION	CONFERENCE	U-SHAPE
Back Bay	1,292	38' x 34'	8'6"	80	80	48	80	34	30
Beacon Hill	850	23' x 43'	8'6"	71	50	48	75	34	36
Brandeis	446	13' x 35'	8'6"	20	20	15	25	16	-
Brookline	396	20' x 23'	8'6"	28	20	15	30	12	-
Cabot	529	20' x 29'	8'6"	40	30	24	45	20	18
Cambridge	892	23' x 44'	8'6"	69	50	48	75	34	36
Charles River	515	19' x 29'	8'6"	44	40	24	45	20	18
Constitution	446	15' x 33'	8'6"	30	30	18	40	16	15
Emerson	398	19' x 26'	8'6"	23	20	12	30	12	15
Franklin	727	18' x 48'	8'6"	57	40	30	60	28	21
Gloucester	471	19' x 33'	8'6"	36	30	15	44	20	15
Holmes	334	15' x 25'	8'6"	20	20	12	32	10	-
Longfellow	284	14' x 22'	8'6"	19	20	12	25	10	-
Newbury	871	29' x 30'	8'6"	58	50	36	60	28	24
St. James	767	15' x 48'	8'6"	46	30	36	55	30	24
Stuart	731	13' x 40'	8'6"	54	40	33	65	30	24
Tremont	1,089	18' x 54'	8'6"	70	50	54	75	40	36
White Hill	1,203	15' x 68'	8'6"	80	60	60	95	40	36
Whittier	1,215	22' x 65'	8'6"	80	60	60	95	40	36
Winthrop	498	23' x 26'	8'6"	39	30	18	45	22	-